

**VITALLY IMPORTANT: TO GIVE OPTIMUM ILLUMINATION TO SIGN FACE SELECT  
CORRECT SETTING 1 OR 2 ON BRACKET FIXINGS WHEN TIGHTENING**

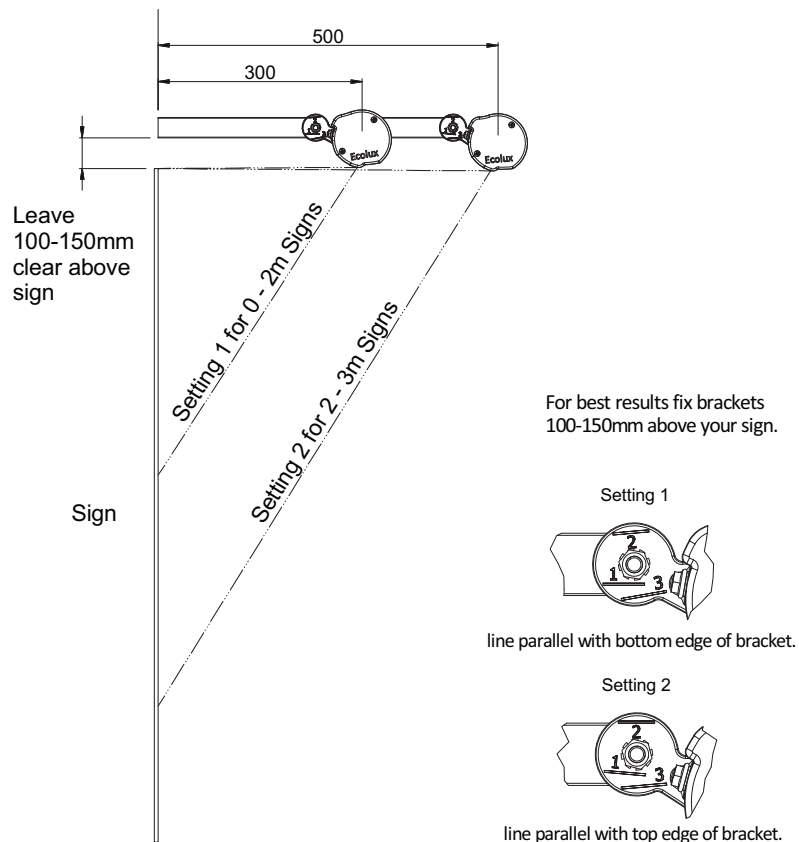

**Important Safety**

Before carrying out any servicing on this luminaire, ensure that the supply is fully isolated.

**technical enquiries**

If you need any help with the installation or maintenance of Portland Lighting products, please contact us

Telephone: **01922 721 133**  
Email: [Sales@portlandlighting.co.uk](mailto:Sales@portlandlighting.co.uk)



Portland Lighting  
Unit 2  
Reedwood Park Road  
Walsall  
WS2 8DQ

# ecolux solar

## INSTALLATION & WIRING INSTRUCTIONS

**1. IMPORTANT: Please read these instructions carefully before proceeding with installation.**

- 1.1 This instruction sheet should be passed on by installer to the end user for maintenance purposes.
- 1.2 It is recommended that the fitting is installed by a competent electrician in accordance with these instructions and appropriate wiring regulations.
- 1.3 Portland Lighting products should not be modified. No responsibility will be accepted for any modified products or for any damage caused as a result of their modification.
- 1.4 It is not recommended to install the fitting in areas that are liable to reach an ambient temperature in excess of 35°C.
- 1.5 To clean fittings use a soft damp cloth and dry immediately. Do not use any chemical/abrasive cleaner.
- 1.6 All fittings are class III fittings. 12V input and should be used in conjunction with provided solar components and attached Ecolux Solar instruction sheet.
- 1.7 The light source contained in this luminaire shall only be replaced by the manufacturer, service agent or similar qualified person.



- 1.8 Type Y Attachment – If the external flexible cable or cord of this luminaire is damaged, it shall be exclusively replaced by Portland Lighting Ltd or their service agent or a similar qualified person in order to avoid a hazard.

The fitting should be mounted on a suitable weight bearing surface, using appropriate fixings (Weight per metre 3kg).



Secure bracket to wall.  
For best results 100-150mm above your sign.



Tighten bracket end to specified setting:  
300mm bracket - 1  
500mm bracket - 2  
Setting 3 - not for use with solar system.



Hang lights on bracket and slide fasteners into position and secure.

# ecolux solar lens

## CONNECTING INSTRUCTIONS

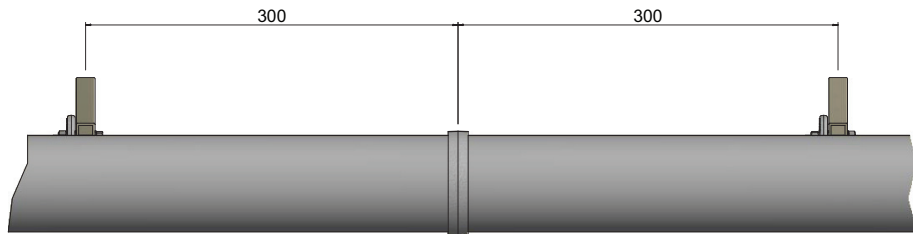

Preparation:- For Best Results Fix Brackets within 300mm Either Side of Join

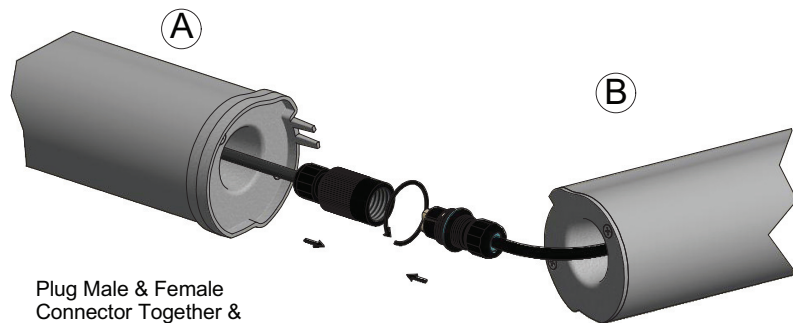

Plug Male & Female Connector Together & Twist to Seal

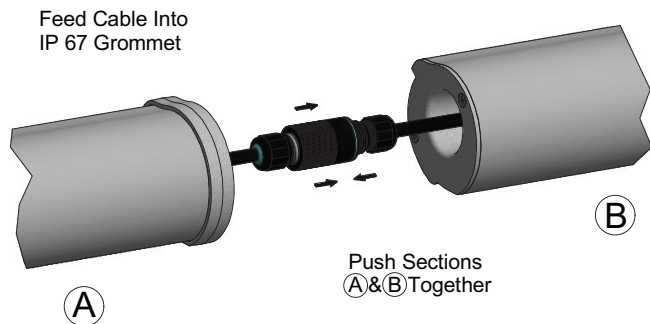

Push Sections A & B Together

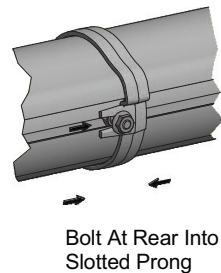

Bolt At Rear Into Slotted Prong

## This Kit includes the following:

- A. Solar PV Panels *(please note the number of PV panels in the kit may vary).*
- B. Splitter Looms
- C. Battery Splitter Loom
- D. 1C0L
- E. PS800 Controller
- F. Batteries *(please note the number of batteries in the kit may vary).*
- G. Battery Box

## Install instructions

### Step 1:

Connect the splitter looms to the PV panels, creating pairs. *(please note the number of PV panels in the kit may vary).*

### Step 2:

Next, connect all of the red wires to the positive (+) side of the batteries (red) and connect the black wires to the negative (-) side of the batteries (black). *(please note the number of batteries in the kit may vary).*

### Step 3:

Next, connect the 1C0L to 1 of the pairs of PV, via the splitter loom you connected in step 1.

### Step 4:

Next, connect the PS800 controller to the other pair of PV

### Step 5:

Then connect the trough light to the PS800 controller, as shown.

### Step 6:

Now connect the single end of the battery splitter loom to the PS800 controller.

### Step 7:

Next, take one of the remaining connectors from the battery splitter loom and plug it into the 1C0L.

### Step 8:

Next, take the remaining connector from the battery splitter loom and connect it to the batteries.

### Step 9:

Finally, take the orange wire from the 1C0L and connect it to the orange wire from the PS800 controller.

Telephone: 01922 721 133

Email: [Sales@portlandlighting.co.uk](mailto:Sales@portlandlighting.co.uk)



Portland Lighting  
Unit 2  
Reedswood Park Road  
Walsall  
WS2 8DQ